

# Anchor<sup>®</sup>



## Cozy Autumn Sweatshirt



[AnchorCrafts.com](http://AnchorCrafts.com)

   @anchorcrafting

Designed by [Anaclara.bordou](http://Anaclara.bordou)

Design No.: ANC0003-87

MEZ Needlecraft GmbH, 2020. All Rights Reserved.



## ANC0003-87 Cozy Autumn – Sweatshirt

Anchor Stranded Cotton 8m No. 4635000- \*(Colour n°)

 1 x #00001; #00108; #00306; #00891; #00860

 N° 7

Embroidery 

Easy 



# Cozy Autumn – Sweatshirt

### MATERIAL

Sweatshirt; 26 cm embroidery hoop with screw; Scissors; Light box or Stabilizer or Transfer paper; Fabric pen (preferably one that vanishes with heat or water - I have used the Pilot Frixion Pen)

### STITCHES USED

- Stem Stitch
- Satin Stitch
- Fishbone Stitch
- Lazy Daisy Stitch
- French knot

### INSTRUCTIONS

#### KICK-START:

1. Print the pattern;
  2. To transfer the pattern to the sweatshirt you can use the method of your choice, for example: - Use a light box and a fabric pen;
  - Use a transfer paper;
  - Use a stabilizer for embroidery.
  3. Place the sweatshirt in the embroidery hoop.
- //At this stage your embroidery will look like IMG\_01.



#### TO EMBROIDER THE YELLOW PLANTS:

1. Using 6 strands of #00891 and STEM STITCH embroider the stems.
  2. With 6 strands of #00891 embroider the leaves with FISHBONE STITCH.
- //See IMG\_02 as a reference.

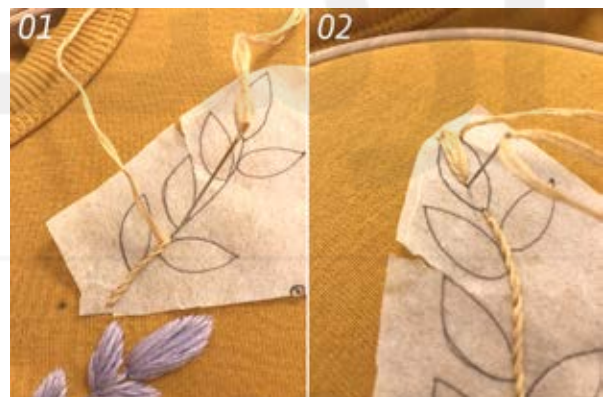

#### TO EMBROIDER THE LILAC PLANTS:

1. With 6 strands of #00108 and STEM STITCH embroider the stems.
2. With 6 strands of #00108 embroider the leaves with SATIN STITCH according to the pattern. //See IMG\_03 as a reference.

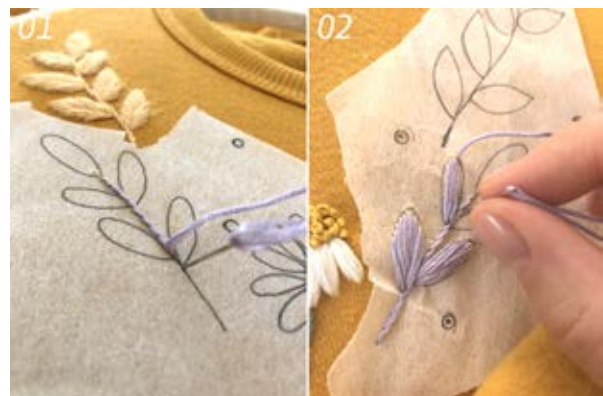



**TO EMBROIDER THE DAISIES:**

1. Stems: With 6 strands of #00860 use the STEM STITCH to embroider the stems and LAZY DAISY STITCH to embroider the leaves;
  2. Petals: With 6 strands of #00001 use the SATIN STITCH to embroider the daisies petals;
  3. Core: With 6 strands of #00306 embroider the center of the flowers with FRENCH KNOTS.
- //See IMG\_04 as a reference.



**TO EMBROIDER THE WHITE DOTS:**

1. With 6 strands of #00001 use FRENCH KNOT to embroider all the white dots.
- //Your embroidery piece is now complete and will look like IMG\_05.

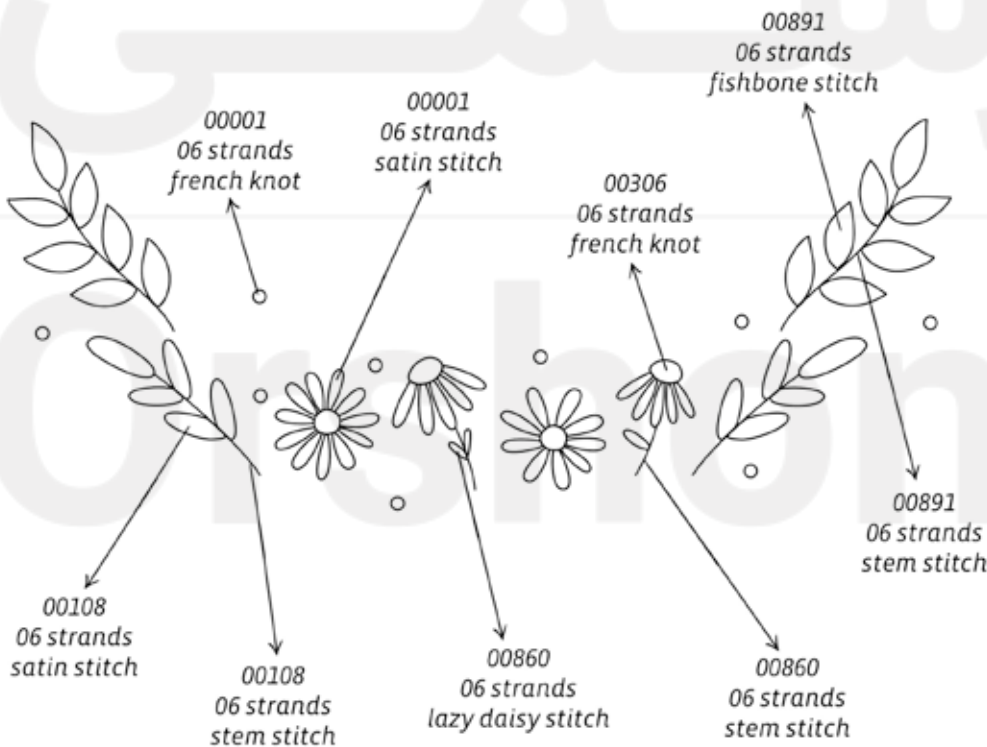

**YARN KEY**

- Anchor Stranded Cotton (6ply)  
 White #00001  
 Lilac #00108  
 Yellow 1 #00306  
 Yellow 2 #00891  
 Green #00860



أرشومي

Orshomi